



**Climate System Analysis Group**



**32nd Annual Conference of the South African Society for Atmospheric Sciences**

**31 October-1 November**

**Hosts: Climate System Analysis Group (University of Cape Town)**

**Lagoon Beach Hotel in Milnerton, Cape Town.**

## **INFORMATION BOOKLET**

**A summary of useful information for participants joining the SASAS Conference**

Sponsor:



## SASAS 2016 DESCRIPTION OF CONFERENCE FACILITIES

SASAS 2016 will be hosted at the four-star **Lagoon Beach Hotel in Milnerton, Cape Town.**

Telephone: 021 528 2000

Email: [info@lagoonbeachhotel.co.za](mailto:info@lagoonbeachhotel.co.za)

Physical Address: 1 Lagoon Gate Drive, Milnerton, Cape Town, South Africa, 7441

GPS CO-ORDINATES: 33°53'31.48"S , 18°28'59.72"E

Postal Address: PO BOX 733, Milnerton, South Africa, Cape Town, 7435



The hotel has panoramic mountain and ocean views with the widest stretch of white sand on Lagoon Beach

Two venues have been booked for SASAS. Each of the venues are air conditioned, wheelchair accessible and each participant will receive 200MB free WIFI per day.

- The Main venue, The Marine Suite is situated adjacent to the hotel entrance.

### The Marine Suite

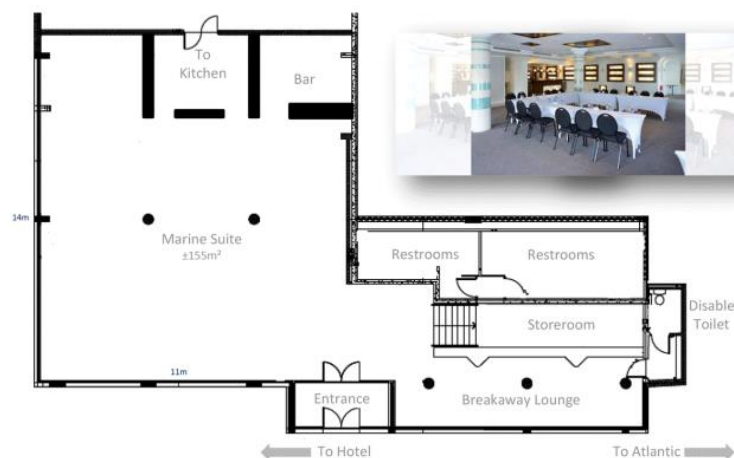

- We have two breakaway rooms, The Library that will be used on the 31st Oct. and The Lagoon View that will be used on the 1st Nov.

### The Library

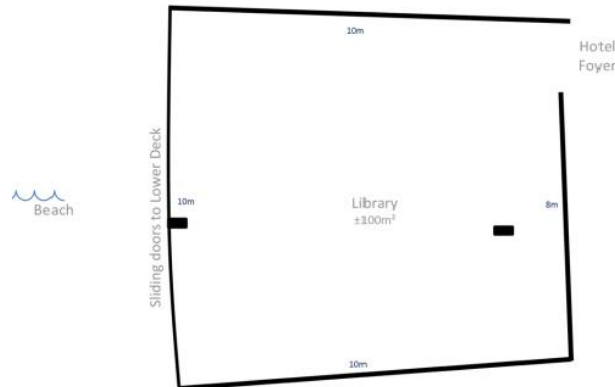

### The Lagoon View

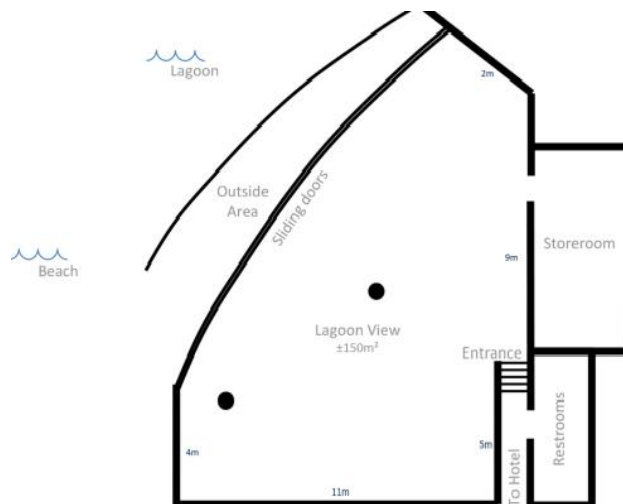

## GUIDELINES FOR TRANSPORT AND PARKING

### TRANSPORT OPTIONS:

#### 1. MyCiti Bus [Cape Town Intergrated Rapid Transit (IRT) System]

There is a MyCiti bus terminal (**Lagoon Beach**) only 100 metres walk away from Lagoon Beach Hotel, along Marine Drive, Milnerton. Busses arrive and depart every 20 minutes, 7 days per week, thus offering secure and safe public bus transport between Table View and Cape Town CBD until 10pm. This is ideal for visitors without alternative transport. The main MyCiti bus trunk route is between Table View and Cape Town Civic Centre.

There are bus stops every few kilometres, including Milnerton Ridge, Milnerton central and Lagoon

Beach. Feeder routes offer connecting bus services into Cape Town CBD and other locations off the main MyCiti trunk route.

There is a MyCiti bus route between the Cape Town Civic Centre and the Airport, offering very convenient, rapid and affordable transport to Cape Town International Airport (approximately R50 one way).

Visit the [MyCiti Bus Website](#) for detailed information and MyCiti brochures.

**Table View to Civic Centre MyCiti Bus Schedule**

Weekdays	
05:45 - 06:30	Every 20 minutes
06:30 - 09:00	Every 8 minutes
09:00 - 15:30	Every 20 minutes
15:30 - 19:00	Every 8 minutes
19:00 - 22:00	Every 20 minutes

Weekends & Public Holidays	
06:40 - 22:00	Every 20 minutes

**Civic Centre to Cape Town International Airport MyCiti Bus Schedule**

04:20 - 21:20	Every 20 minutes
---------------	------------------

**Cape Town International Airport to Civic Centre MyCiti Bus Schedule**

05:10 - 22:00	Every 20 minutes
---------------	------------------

**2. Taxis**

Public transport within Cape Town is via train, bus or mini-bus taxis. Although, it is generally safe to use public transport, you may find that it is easier to use private taxis. The following numbers are provided – you can ring and ask to be picked up and also check on fares beforehand. You may also find taxis in the town centres.

<b>Rikkies Taxis</b>	0861 745 547 This cab service is available for point-to-point rides as well as share rides around Cape Town CBD and Waterfront area.
<b>Unicab</b>	021 448 1720
<b>Grab a Cab</b>	021 556 6344
<b>Excite Meter Cab</b>	021 418 4444

**Taxi rates can be negotiated and it's best to ask before departing on the cost of the ride.**

### 3. Uber

From Cape Town International Airport to Lagoon Beach Hotel, Cape Town

[Signup at uber.com](https://www.uber.com)

Details:

**uberBLACK** approx: R 250 - R 340

**uberX** approx: R 140 - R 200

**uberXL** approx: R 160 - R 210

#### **PARKING FACILITIES AT THE LAGOON BEACH HOTEL:**

The Lagoon Beach Hotel is located 20 km from the Cape Town International Airport and a 20-minute drive from Table Mountain. It also provides secure underground car parking.

#### **FOR THOSE STAYING AT THE LAGOON BEACH HOTEL:**

Should you have any shuttle/airport transfer needs please contact the hotel directly for details on their dedicated in-house travel team. For those staying at the hotel, there is a free complimentary shuttle service to and from popular tourist locations at predetermined times each day, inquire through the hotel.

#### **DIRECTIONS TO LAGOON BEACH HOTEL:**

##### **1. Directions from the N1**

On the N1 towards Cape Town - Take the R27 Table View off-ramp. Follow the road until you come to a robot at the corner of Boundary & Marine Drive. Turn left towards the beachfront into Lagoon Gate Drive. Proceed along with Lagoon Gate Drive, around a circle and turn right into the underground parking of the hotel or you can proceed to the front entrance to the hotel.

##### **2. Direction from the N2 (Cape Town International Airport)**

On the N2 towards Cape Town - Take the M5 Milnerton off-ramp/exit which leads onto Koeberg Road. Continue on Koeberg Road until you reach the robots at the corner of Koeberg and Boundary Road. Turn left at the robots into Boundary Road. At the next set of robots, proceed straight across and into Lagoon Gate Drive. Proceed along with Lagoon Gate Drive, around a circle and proceed straight to the hotel's main entrance.

##### **3. Direction from Cape Town Centre**

From the City Centre take N1 towards Paarl - Take the Paarden Eiland/Table View R27 off-ramp/exit which leads onto Marine Drive. Follow Marine Drive until you get to the robots at Marine Drive and Boundary Road. Turn left into Lagoon Gate Drive. Proceed along the road, around a circle and straight to the hotel's main entrance.

## REGISTRATION ON DAY 1

Registration will take place between 08:00-08:45 at the Main venue, The Marine Suite (situated adjacent to the hotel entrance). If you are delayed please proceed to join the group in the room and we will complete the process during the first tea break.

## PROGRAMME

Please find below the programme for the conference. Poster viewing will take place on Day 1, 31 October, followed by the Gala Dinner at 19:00 (for those that have indicated on their registrations forms that they will be attending).

### PROGRAMME DAY 1: 31 OCTOBER

KEY: \*STUDENT

<b>0800-0845</b>	<b>REGISTRATION</b>
<b>0845-0900</b>	<b>WELCOME (Dr Peter Johnston) AND HOUSEKEEPING (Mrs Kate Kloppers)</b>
<b>0900-0930</b>	<b>KEYNOTE ADDRESS</b>
	Prof William Gutowski Water and Climate Change (WACC): Building Community Consensus for a Sustainable Future
<b>0930-1000</b>	<b>INVITED SPEAKER</b>
	Dr Yushi Morioka Role of Weddell Sea ice variability in southern African climate
<b>1000-1030</b>	<b>TEA BREAK</b>

### 1030-1230 SESSION 1

PARALLEL

1A		<b>Climate Modelling and Development (Chairperson: Chris Lennard)</b>	
1	1030-1045	Elelwani Phaduli	Evaluation of the Convective Scale Configurations of the Unified Model
2	1045-1100	Francois A. Engelbrecht	Dynamic core of the Variable-resolution Cubic Ocean Model (VCOM)
3	1100-1115	Magdel Erasmus*	Tropical Temperate Troughs over Southern Africa as Simulated by a Fully Coupled Model
4	1115-1130	Mary-Jane Bopape	Simulating the Convective Boundary Layer with a Dynamic Smagorinsky Model
5	1130-1145	Mavhungu S Muthige*	Impacts of spectral nudging on the simulation of present-day rainfall patterns over southern Africa
6	1145-1200	Rachel James	Representation of Tropical Temperate Troughs over southern Africa in coupled climate models

### 20 MIN DISCUSSION

1B		<b>Ocean Dynamics and Atmosphere-Ocean Interactions (Chairperson: Marcello Vichi)</b>	
1	1030-1045	Mathieu Rouault	Wind changes above warm Agulhas Current eddies

2	1045-1100	Marc de Vos	Towards understanding the impact of assimilating along-track SLA data on simulated eddy characteristics in the Agulhas System
3	1100-1115	Teboho Nchaba	Summer circulation trends over southern Africa and its adjacent oceans
4	1115-1130	Tharone Rapeti	Preliminary investigation into the impacts of assimilating SST and SLA on the surface velocities in a HYCOM of the Agulhas Current
5	1130-1145	Daneeja Mawren*	Variability of tropical cyclone heat potential and barrier layers in the South Indian Ocean
6	1145-1200	Fehmi Dilmahamod*	Investigating the regime of the South-West Indian Ocean Currents through a numerical model.

### 20 MIN DISCUSSION

1230-1330 LUNCH

1330-1410 POSTER PRESENTATIONS (1 MIN X 30)

PLENARY

1410-1550 SESSION 2

PARALLEL

2A	Climate Modelling and Development (Chairperson: Babatunde Abiodun)		
1	1410-1425	Stephanie Landman	Predictability of Rain-Bearing Systems over South Africa by Regional and Global Weather Prediction Models
2	1425-1440	Syamala Krishnannair	Comparative study of PCA and wavelet-PCA models for simulating monthly rainfall and temperature for Cape Point station
3	1440-1455	Willem Conradie*	Initial Conditions and Quantifying Model Climates: Does it Matter Where We Come from?
4	1455-1510	Georges-Noel T. Longandjo	How does well ECHAM simulate central Africa rainfall seasonal cycle?
5	1510-1525	Asmerom Beraki	Covariability of remote and local climate forcings and South African winter climate predictability

### 20 MIN DISCUSSION

2B	Atmosphere/Ocean Interaction, Aerosols and Atmospheric wave dynamics (Chairperson: Venkataraman Sivakumar)		
1	1410-1425	Kirodh Boodhraj*	An assessment of the role of vertical mixing schemes in the simulation of Southern Ocean upper dynamics
2	1425-1440	Neil Hart	Upper-level jets and eddies associated with tropical-extratropical cloud bands over southern Africa: The seasonal cycle
3	1440-1455	Xolile Nciphha*	Comparison of summer and spring carbon dioxide vertical and spatial distribution over the Southwest Indian Ocean Islands using TES data

4	1455-1510	Anzel Swart*	An Analysis of the Air Dispersion Potential (ADP) over Uubvlei in Oranjemund, Namibia.
5	1510-1525	Majambo Gamoyo*	Mesoscale dynamics in the Western Indian Ocean (Focus on the Southern Gyre): A numerical investigation using ROMS

**20 MIN DISCUSSION**

**1550-1610 TEA**

**1610-1730 SESSION 3**

**PARALLEL**

<b>3A</b>		<b>ENSO and seasonal impacts (Chairperson: Asmerom Baraki)</b>	
1	1610-1625	Christien J. Engelbrecht	The 2015/16 Summer vs the Summers of the Last Decade
2	1625-1640	Willem A Landman	Decision-relevant information on seasonal time scales - the case of a farm in northern Namibia
3	1640-1655	Hector Chikoore	Evolution of the 2015/16 El Niño drought: circulation anomalies, heat waves and impacts on southern Africa
4	1655-1710	Takayoshi Ikeda	Linking malaria in Limpopo, South Africa to climate using self-organizing maps

**20 MIN DISCUSSION**

<b>3B</b>		<b>Atmospheric Air Quality (Chairperson: Nkanyiso Mbatha)</b>	
1	1610-1625	Maluta Pennington Mbedzi*	The potential use of CCAM as a meteorological driver to air quality mode over the Waterberg-Bojanala Priority Area
2	1625-1640	S.K. Sangeetha*	Comparative study of OMI BRD and PCA algorithm retrievals in relation to ground based measurements over a South African Site
3	1640-1655	Sewela Malaka*	Contribution of dairy farming on climate change through direct methane emissions to the atmosphere
4	1655-1710	Lynette V Schalkwyk	Warning South Africa when severe weather unfolds

**20 MIN DISCUSSION**

**1730-1830 POSTER VIEWING (see poster presentation list below)**

**1730-1830 SASAS BOARD MEETING (by invitation only)**

**1900 GALA DINNER**



## DAY 2: 1 NOVEMBER

<b>0830-0900</b>	<b>KEYNOTE ADDRESS</b>
	Prof Tim Carter Modelling impacts of climate change: what are the information needs?
<b>0900-0930</b>	<b>INVITED SPEAKER</b>
	Prof Mike Savage Open water evaporation quo vadis?

<b>0930-1030</b>	<b>SESSION 4</b>	<b>PLENARY</b>
------------------	------------------	----------------

<b>4</b>		<b>1.5 Degrees, Climate Services and application (Chairperson: Mark Tadross)</b>	
1	0930-0945	Coleen Vogel	“END of END user!” – Transdisciplinary approaches in climate science.
2	0945-1000	Bruce Hewitson & Katinka Waagsaether	The evolving landscape of Climate Information Websites
3	1000-1015	Piotr Wolski	Improving visualisations of climate projection information

**15 MIN DISCUSSION**

<b>1030-1100</b>	<b>TEA</b>
------------------	------------

<b>1100-1300</b>	<b>SESSION 5</b>	<b>PARALLEL</b>
------------------	------------------	-----------------

<b>5A</b>		<b>Applications for water and agriculture (Chairperson: Piotr Wolski)</b>	
1	1100-1115	Harold Weepener	Climate change related impact on avocado production areas in South Africa
2	1115-1130	Johan Malherbe	How would current advice benefit maize farmers with respect to historical associations with El Niño events
3	1130-1145	Shepherd Muchuru	Mitigating vulnerability to drought and enhancing livelihood resilience: A review of Southern Africa region
4	1145-1200	Teboho Masupha*	Temporal evolution of agricultural drought in the Luvuvhu River catchment of South Africa
5	1200-1215	Yao Télésphore Brou	Spatio-temporal variability of rainfall and impacts on vegetation in Reunion Island
6	1215-1230	Lisa van Aardenne	Climate and Tsetse: exploring the effect of climate variability and change on vector biology, population dynamics and distribution in the Zambezi Valley

**20 MIN DISCUSSION**

5B		Instrumentation and data collection (Chairperson: Mike Savage)	
1	1100-1115	Alexa Brown*	Time, space and vector relationships between historical ship log data and Cape Royal Astronomical Observatory wind data between 1834 and 1854
2	1115-1130	Yerdashin Padayachi	Anthropogenic Heat Flux in South African Cities: Initial estimates from the LUCY model
3	1130-1145	Morné Gijben	Recent improvements to the rapidly developing thunderstorm product - the addition of lightning data into the software
4	1145-1200	Erik Becker	Application of radar data at the South Africa Weather Service
5	1200-1215	Nkanyiso Mbatha	Stratosphere-troposphere exchange climatology over southern Africa using ERA-Interim data set and AIRS/Aqua satellite data
6	1215-1230	Zakhele Shabalala*	Development of a patching tool on recorded daily climate data

### 20 MIN DISCUSSION

1300-1400 LUNCH

1400-1530 SESSION 6

PARALLEL

6A		Climate & weather forecasting (Chairperson: Willem Landman)	
1	1400-1415	Henno Havenga*	High Resolution dBz simulation of some notable hailstorms that occurred in 2013 over the South-African Highveld using WRF
2	1415-1430	Melise du Toit*	The application of support vector regression (SVR) for stream flow prediction on the Amazon basin
3	1430-1445	Kelebogile Mathole	The climatology of the stratospheric zonal wind and its wave driving in the SAWS operation seasonal prediction system
4	1445-1500	Izidine Pinto*	Process-based assessment of two CORDEX climate models projections over southern Africa
5	1500-1515	Elizabeth Webster	Impact-based severe weather warning system

### 15 MIN DISCUSSION

6B		Dust - Southern African aerosols, sources pathways and impacts (Chairperson: Frank Eckhardt)	
1	1400-1415	Johanna von Holdt*	Aeolian dust emission from the Namib Desert: local-scale erodibility controls
2	1415-1430	Rebecca Garland	Representation of aerosol particles and associated transport pathways in regional climate modelling in Africa
3	1430-1445	Priyanka Singh*	Validation and comparison between Aerosol Optical Depth acquired from Sun Photometer and MODIS satellite over Durban
4	1445-1500	Thabo Makgoale*	The sensitivity of simulated temperatures in climate models to aerosols over southern Africa
5	1500-1515	Ruusa Gottlieb*	The contribution of fog to the biogeography of <i>Arthraerua leubnitziae</i> in the central Namib desert

### 15 MIN DISCUSSION

1530-1550 TEA

1550-1600 AWARDS AND CLOSING

1600-1700 AGM

**Poster presentations**

Main Author	Title	Student	Board No.
Bellinda Monyela	Abnormal climate conditions for summer 2014/2015 over southern Africa	*	1
Chris Lennard	Characterizing surface level inversions over Cape Town, South Africa		2
Claire Davis	Climate change and extreme weather events in Southern Africa: can countries adapt?	*	3
Cobus Olivier	Making seasonal forecasts easier to use		4
Eve Wicksteed	Air Pollution and Climate Change in the Greater Cape Town Area	*	5
Fabien Desbiolles	Air-Sea interactions over the Angola-Benguela Frontal Zone and their effects on regional atmospheric circulation	*	6
Jan Vermeulen	Late plum rain over northeastern South Africa: 1 to 14 March 2014		7
Kabelo Mathibela	Testing the applicability of the NAME III dispersion model in predicting air pollutants concentrations over the VTPA		8
Kaukurauee Ismael Kanguuehi	Trace metal concentration and solubility of aerosols from southern Africa sources transported over the ocean	*	9
Kelsey Woor	Assessing the Risk of Failure and Implications to Investment Payback Period for Domestic Rooftop Rainwater Harvesting Systems under Current and Future Climate in the Western Cape	*	10
Kwesi Quagraine	Regional climate model based simulations of inter-annual rainfall variability over the Guinean coast of West Africa	*	11
Lerato Mpheshea	Predictability of seasonal streamflow in the north-eastern region of South Africa	*	12
Mariam Nguvava	The influence of atmospheric teleconnections on drought regimes in Eastern Africa	*	13
Mark Jacobson	Topographic effects on the wind field in False Bay	*	14

Modathir Abdalla Hassan Zaroug	Are semi-arid regions hotspots of climate change in Africa and South Asia?	*	15
Molulaqhoora Maoyi	Simulating the characteristics of Tropical Cyclones over the South West Indian Ocean using an Adaptive Stretched-Grid Global Climate Model	*	16
Morwakoma Matabane	Ocean wave forecasting in the southern African region: the use of ECMWF WAM and NCEP Ensemble data	*	17
Mthetho Vuyo Sovara	Modeling the impacts of the Indonesian Throughflow on the Indian Ocean using the Parallel Cubic Ocean Model	*	18
Mthobisi Nxumalo	Analysis of homogenised extreme temperature trends over South Africa for the period 1931 to 2015		19
Neil Hart	The spatial distribution and variability of organised convection over southern Africa as represented by cold cloud duration		20
Njabulo Mchunu	Evaluating the Multi-Scale Predictability of a Severe Weather Event Associated with a Cut-off Low over South Africa		21
Piotr Wolski	Interannual rainfall variability and SOM-based circulation classification		22
Ramapulana Nkoana	Koppen-Geiger climate type maps of the Last Glacial Maximum over south coast	*	23
Rodger Duffett	Toward a UAV Sonde: Characterising a Quadcopter for wind speed measurements		24
Ruchith Ramakrishnan Devaki	Influence of aerosol-cloud interaction on austral summer precipitation over southern Africa during ENSO events		25
Tania Moyikwa	Wind variability along the southern coast of South Africa	*	26
Tania Williams	The changing rainfall patterns over Western Cape	*	27
Victor Indasi	Climate data in southern Africa: Agreements and contradictions	*	28
Zane Dedekind	The effect of prognostic aerosols on simulated stratocumulus over the southeastern Atlantic		29

## INSTRUCTIONS FOR ORAL PRESENTATIONS

1. Please ENSURE that you have preloaded your POWERPOINT presentation with the technician, **AT LEAST 1 SESSION BEFORE** your presentation. If your presentation is in the first session in the morning, you must do this **BY THE PREVIOUS DAY'S CLOSING**.
2. Confirm that your **name** and **title** in the programme corresponds to the actual presentation. If there are any changes, please report them to the session chair.
3. Remember the time limit of 15 minutes– usually 10-12 minutes for the talk and 3-5 for questions. If you would prefer to take up the full 15 minutes, there will be no extra time given for questions.
4. You will be reminded of your time elapsed with 5-minute card, then 2-minute card, then the bell will ring when the 15 minutes is up. **YOU MUST STOP IMMEDIATELY**.
5. Please try to allow 3-5 minutes for 2 questions. They will be taken one at a time. After the questioner has put their question the chair will repeat it to the audience. The number of questions is limited by the time. After the session's talks are complete you will be asked to go up to the stage for 20 minutes of discussion, where you may be asked other questions. Other questions must be dealt with privately during the break.
6. If there is a no-show, the programme will NOT be altered by moving presentations up or around.

**IT IS ESSENTIAL THAT THESE INSTRUCTIONS AND TIMES ARE STRICTLY ADHERED TO. Thank you.**

## GUIDELINES FOR POSTER PRESENTATIONS

1. Please ensure your poster is ready for erection by the first tea break
2. The poster should be put up in the space allocated to you, recognised by the number on the index sheet which will be posted up in various places and listed in the abstract book.
3. The size should be **A0 and Portrait orientation**.
4. Poster presenters will be given **ONE minute** after lunch on Day 1 to announce their poster. This should entail:
  - a. Summarising the gist of your poster
  - b. Encouraging delegates to view it and suggesting why they should
5. Poster presenters are encouraged to stand with their posters during breaks, and after the end of Day 1, in order to engage with those interested, and preferably have some sort of contact detail flier available to hand out.
6. If you wish to retain your poster please remove it during the final tea break or directly after the AGM. **Posters left up after this will be discarded.**

## LUNCH AND REFRESHMENTS

All lunches, tea and coffee during the conference will be provided for the participants. Catering is provided by the Lagoon Beach Hotel Conference Organisers, the food is Halaal friendly. Water will be provided in each of the conference facilities. Please make sure you have alerted us of any special dietary requirements if you have not done so already.

## WEATHER IN CAPE TOWN

The average maximum temperature for October/November is between 21°C and 23°C and minimum between 11°C and 13°C. Please note that the inside conference venues are air-conditioned, therefore its best to bring along a jacket if you feel the cold easily.

## SECURITY

Cape Town is reasonably safe but crime does exist, therefore, precautions must be taken. Be street wise, and don't carry all your cash with you - use your hotel safe that is available in all rooms. Use marked taxis or buses to move between areas. Try not to have cameras/electronic devices loose and try to make yourself look like a local. **Do not allow** strangers to assist you at ATM's as there are several ATM scams in operation. Try to explore in groups and stick to well-lit streets especially at night and this also includes the walking routes up Table Mountain.

If driving, store parcels out of sight in the boot of the car and do not leave luggage unattended. Park in well lit areas at night and drive with your doors locked and your windows closed. Be alert at traffic lights.

## SHOPPING

There are many malls and craft markets within easy reach in Cape Town. Some are listed here;  
**Cavendish Square** – large mall in Claremont with over 200 shops, cinemas and restaurants.  
**Greenmarket Square** – craft market, off Burg Street in the centre of town with carvings, masks and drums, beadwork, jewellery, clothing, leatherwork and ceramics.  
**Canal Walk** - a large shopping mall just outside the Cape Town city centre, with hundreds of stores, cinemas, indoor karting track, skate park, gaming arcade, and restaurants, open until 21:00. Located on the N1 ten minutes drive north of the city.  
**V & A Waterfront** – lots of high quality shops, cinemas and restaurants at the city harbour.

## SIGHT-SEEING

Cape Town is a world renowned tourist destination and has many attractions for visitors. Some of the more popular destinations and activities are listed here.

**Table mountain** – the city's largest landmark. A cable car runs from the bottom of Tafelberg road to the top of the mountain. There are many walks at the top and one can also hike to the top via the many paths up. However, **please note that some of these paths are quite difficult and it's advisable to go with an experienced person.**

**Kirstenbosch Gardens** – botanical gardens situated near the University of Cape Town with a large variety of plants unique to South Africa. Beautiful garden to spend a sunny afternoon strolling in.

**Cape Point** – southern most point of the peninsula. The drive to Cape Point is also very beautiful but does take about 40 minutes.

**Robben Island** – located about 30minutes boat ride from the waterfront. Prison where Nelson

Mandela was incarcerated for 27 years. Visits to this venue need to be pre-booked and will depend on weather conditions on the day.

**Wine tasting** – Western Cape has several wine producing regions. Some of these include Constantia, Stellenbosch, Paarl and Franschhoek. There are hundreds of farms in the area and many are open for tastings.

NB – if you are interested in sightseeing and do not have your own transport, a good option is the open top double-decker bus 'City sightseeing'. A 2-day ticket will cost ~R200 and will take you to all the major tourist destinations <http://www.citysightseeing.co.za>

## IMPORTANT NUMBERS

Police Milnerton ----- 021 528 3800

Netcare 911 (for medical emergencies) ----- 082911